

Peregrine Voyager



Peregrine Adventures – Program Description **POLAR VOYAGES**

Peregrine is regarded as one of the world's leading expedition cruise operators. Peregrine has a unique program that is high quality, safe, and environmentally responsible. Peregrine's ships are among the top few in the industry for comfort, safety, and functionality. They are among the most modern in the industry and are very comfortable.

Our program is gaining recognition for its unique, 'flexible' approach. Using the ship as a multipurpose platform from which we base our activities, we aim to remove the 'group feeling' from this type of group travel. We offer a range of activities at each and every stop so that a wide variety of client interests is satisfied. Clients will regularly hear the question, "What would you like to do?" They can be as adventurous as they wish and participate to their own level of interest and ability. Our staff-to-client ratio far exceeds the industry norm, which means there are always plenty of staff on hand; we can offer a greater variety of activities and our program runs more safely and efficiently. Whether it's kayaking, hiking, walking, camping, photography, ornithology, whale watching or cruising, our staff ensure everyone is taken care of. We even offer the opportunity to try snowshoeing!

We also have a great on-board educational program that is delivered in a friendly way by a team of expert naturalists, historians and adventurers in our dedicated presentation theatre.

The *Peregrine Voyager* is an ice-rated vessel, highly manoeuvrable and very stable that we're introducing after an extensive refit and refurbishment in May of 2003. She is widely regarded as the best ship in her class operating in Polar waters. The cabins are very comfortable with most including lower berths and private or semi-private facilities. The ample public spaces are very comfortable and social, and include a library, panoramic bar & lounge, presentation theatre, reading room, sauna, swimming pool and accessible bridge. The dining room seats all passengers in one sitting and is run in a friendly and informal way. The ship, overall, is a truly modern, bright, clean, and very professionally-run Polar expedition ship with an ever-present focus on customer service.

Safety is our paramount concern and we ensure that we not only meet, but exceed safety requirements in all areas of our operation. Our staff members are thoroughly trained in safety and first aid, and, whether on board, ashore, or in the zodiacs, we carry a comprehensive inventory of emergency and safety equipment.



The *Peregrine Voyager* allows for maximum time ashore experiencing Antarctica and the Arctic. On-shore excursions are conducted using sturdy, inflatable zodiac boats, which allow easy and safe landings. We carry enough equipment so that all passengers can be carried away from the ship at once in our fleet of zodiacs so there is minimal waiting time.

We adhere to - and exceed - the environmental guidelines of the International Association of Antarctic Tour Operators (IAATO — of which we are a full member) and work in an open and consultative way with the Australian Antarctic Division, aiming to set the industry standard of environmental best practice.

Whether guiding the shore excursions or leading on-board discussions and presentations, our expert leaders and staff ensure our clients understand and learn from their Polar adventure.

Our past and repeat clients agree - it's the most extraordinary holiday experience they've ever had!

The Spirit of Adventure

Peregrine Voyager



Ship's Notes for the PEREGRINE VOYAGER (the "AKADEMIK SERGEY VAVILOV")

These notes should be read in conjunction with Peregrine's Antarctic Trip Information Guide.

The *Peregrine Voyager* is a modern, ice strengthened vessel that is very comfortable and ideally suited for polar exploration. The vessel was extensively re-fitted during May of 2003 and she now features all the modern facilities and comforts to be expected in a polar exploration vessel. There is a panoramic bar/lounge, library, video room, and dining space for the full passenger complement in one seating. There is also a gymnasium, sauna and swimming pool. There is ample space for meetings of the full group as well as smaller rooms for more intimate meetings. Slide and video projection equipment are available, as well as overhead projection and computer/data projection in our state-of-the-art presentation theatre.

Comfort

As a relatively new Scandinavian-built exploration vessel, the *Peregrine Voyager* is very comfortable, especially following the refitting and refurbishment in May of 2003. All



passenger areas are thoroughly heated and air-conditioned. Cabins are tastefully and pleasantly decorated. The vessel is maintained to the highest standards and is kept immaculately clean.

As the ship was built to perform delicate and sensitive hydro-acoustic work, she is also designed to run very quietly. In cabins and public spaces there is very little if any ambient noise from engines or machinery. Further, most passenger cabins (except the Main Deck cabins) are on a separate deck from the well-used public spaces and lounge areas, so noise is seldom a bother.

Stability and Safety

This vessel has external stabilizers on her hull. She also has a built-in trimming system which is operated by the flow of water ballast from

tanks in either side of the ship. A series of valves causes the water to flow to the side where its presence guarantees greatest stability.

Added to her modern hull design, these systems make for a very stable ship.

The *Peregrine Voyager* carries all current certifications required by law for ensuring passenger safety and wellbeing. All equipment and systems are inspected and tested regularly. A lifeboat briefing and drill will be conducted early in each expedition to ensure that all passengers are familiar with the location of life jackets and lifeboats, and the procedures to be followed in the highly unlikely event of an emergency.

With her two powerful engines this ship rarely suffers significant delays due to inclement weather. She has a cruising speed of 14.5 knots in calm wind/sea conditions. The ship's speed capabilities allow us added flexibility in planning our itineraries.

Bridge

On Deck 6 the ship's bridge is open to passengers virtually 24 hours each day. With an officer and sailor (and often the captain) on watch, you are always able to learn something.



The chart and navigation room is open to everyone, as are places to view the equipment and instruments. The bridge is a fascinating part of the ship and often a great place for sightseeing and bird watching – it provides a great view!

Peregrine Voyager



Communications

The ship carries all required communications and navigation facilities and equipment. She has Immarsat telephone and fax equipment as well as a variety of shortwave, SSB, and VHF radio systems. She also carries fully current GMDSS (Global Marine Distress and Safety System) equipment.

Panoramic observation lounge

On the top deck to the aft of the bridge there is a large panoramic observation lounge. It is a very comfortable room with large windows all around. This spot is tastefully furnished



with an ample supply of comfortable sofas, chairs, and bar stools and has seating for about 85 people. There are also a number of traditional bar stools surrounding a large semi-circular bar. There is a stereo with CD player in the bar area. If you are interested in where we are going, there is also a television monitor showing video of the view from the bridge at all times as well as a modern chartplotter located in the corner for keeping up with the navigators' efforts. There is also a great collection of games and puzzles.

A quick exit can be made to a large outer deck which is supplied with deck chairs and is a great vantage point for iceberg and wildlife spotting.

Dining Room

Located on the main deck our dining room seats all passengers comfortably in one sitting. It is attractively lit and comfortably furnished. There are outside windows and it is immaculately maintained. In one corner there is a bar which is used for meal times. There is also a comfortable lounge area in this corner. Lunches and dinners are served to the table by our ship's stewards, and breakfast is served here also but is buffet style. In the dining room there is also a television monitor relaying video images of the view from the bridge at all times.

Elevator

In addition to the stairs between decks, there is one lift/elevator on the ship operating between all passenger deck levels and to the

bridge level. (Please note that this does not remove the need for passengers to have a reasonable level of mobility, as ship access to and from zodiacs is by way of a staired gangway (please see Trip Information Guide).

Gift Shop

On the Main Deck there is a small kiosk and gift shop. It carries a selection of souvenir items such as postcards, hats, t-shirts, and books to bring home from a voyage. It also has a basic supply of toiletries such as sunscreen, lip balm, usually some film and some camera batteries. It is open each day.

Gynasium

There is a small gymnasium on the ship with a set of free weights, exercise bike, rowing machine, and step trainer.

Infirmary

(Please refer also to Peregrine's Antarctic Trip Information Guide.)

On Deck 5 there is a basic infirmary and crew doctor available for passengers. As the ship was designed for extended projects, she carries an impressive list of equipment and supplies. However, passengers are reminded that this facility is intended as a basic or emergency service. While the inventory of medicines and equipment is extensive, passengers should bring their own basic first-aid kit as detailed in the Trip Information Guide for any minor problems, and if using specific medications should ensure they bring a supply adequate to last the entire journey. If there is a need to consult the ship's doctor and to receive medications, etc., from the infirmary passengers will be invoiced for the cost of any items supplied.

Library

On deck five and forward, situated in a quiet part of the ship, there is a library area. With a large conference table, comfortable chairs, and sophisticated décor this serves as a great, quiet space to read from our selection of expedition reference materials, atlases, magazines, novels and the like. There are attractive wooden bookcases and quality lighting. There are also windows which overlook the bow of the ship for good sightseeing from indoors.

Just outside the library itself there is another quiet area with good lighting and very comfortable armchairs which is usually also reserved as a reading room. The library also has a slide screen and whiteboard for smaller discussions and meetings. It seats about 20.

Peregrine Voyager



Mud Room

Towards the aft section of the main deck, and not far from where you will disembark from the zodiacs, there is a “mud room” where you can change out of your wet-weather gear on returning from shore excursions and leave your waterproof rubber boots. In science days this area was known as the antenna room and really served as the heart of the ship's research program with its elaborate moon pool and antennae equipment.

Presentation Room

Our presentations take place in a comfortable theatre on deck 1.

At 2 levels below our main deck this is the most stable, quiet, and comfortable area of the ship. All

passengers can be seated there “theatre style” at the same time and it has a PA system to ensure everyone can hear talks and announcements. It has a TV and VCR to help in programming as well as modern projection facilities and screens.



Sauna and Swimming Pool

On Deck 5 there is a small swimming pool and a sauna. A plunge pool really, the former is filled on special occasions or on request and is on the outer deck just outside the sauna. It gets a certain level of use, even in the Antarctic waters! The sauna is open each afternoon and evening and seats about six people – it is a great place to relax after your shore excursions. It also has a change room and shower room.

Top Deck

There is also a spacious open top deck; from here you can enjoy spectacular views.



Peregrine Voyager

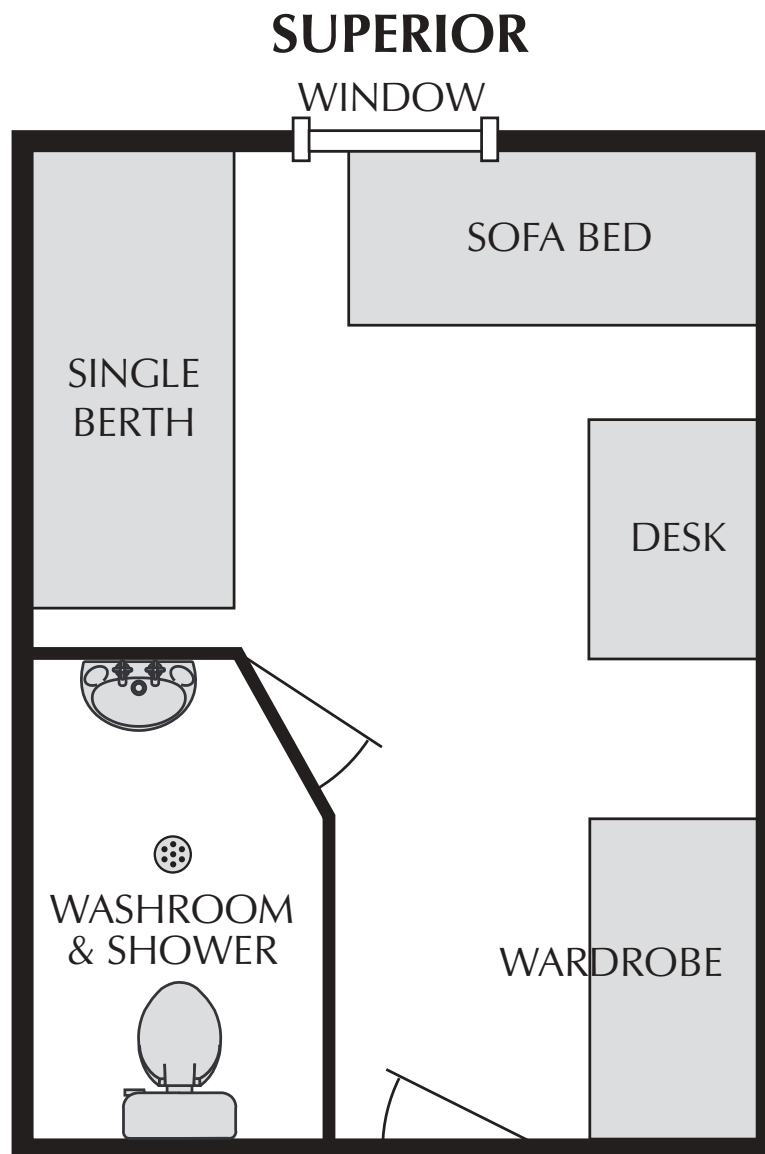

Note: Diagram is not to scale. Some individual cabin layouts may vary.

Peregrine Voyager



MAIN DECK TWIN

PORTHOLE

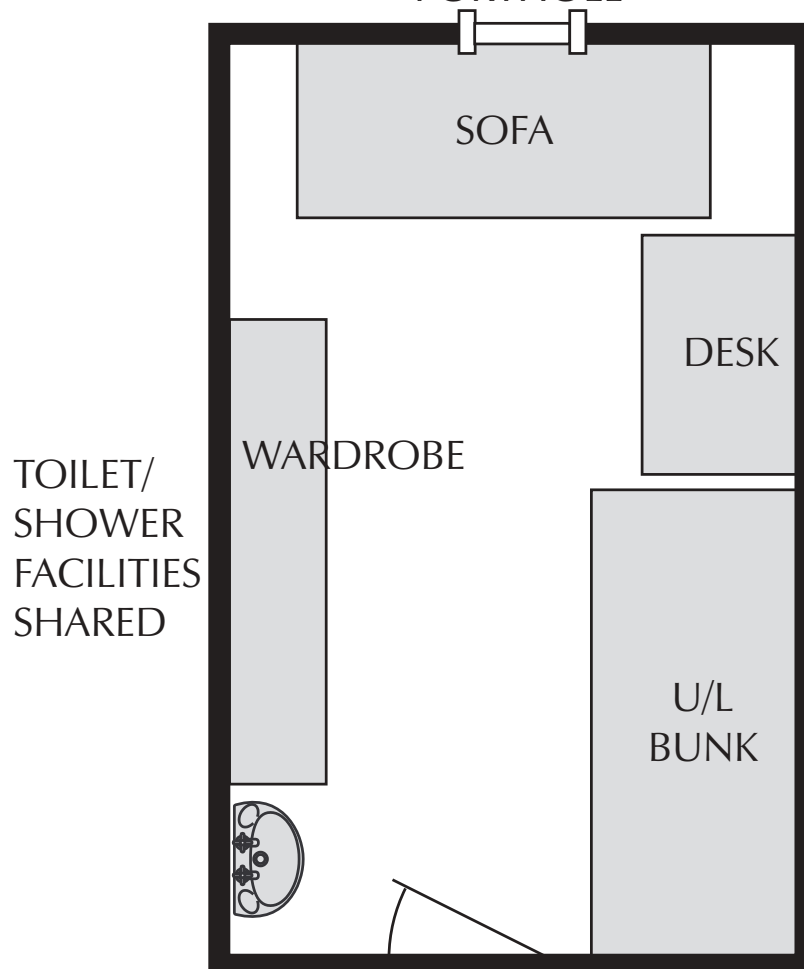

Note: Diagram is not to scale. Some individual cabin layouts may vary.

Peregrine Voyager



MAIN DECK TRIPLE PORTHOLE

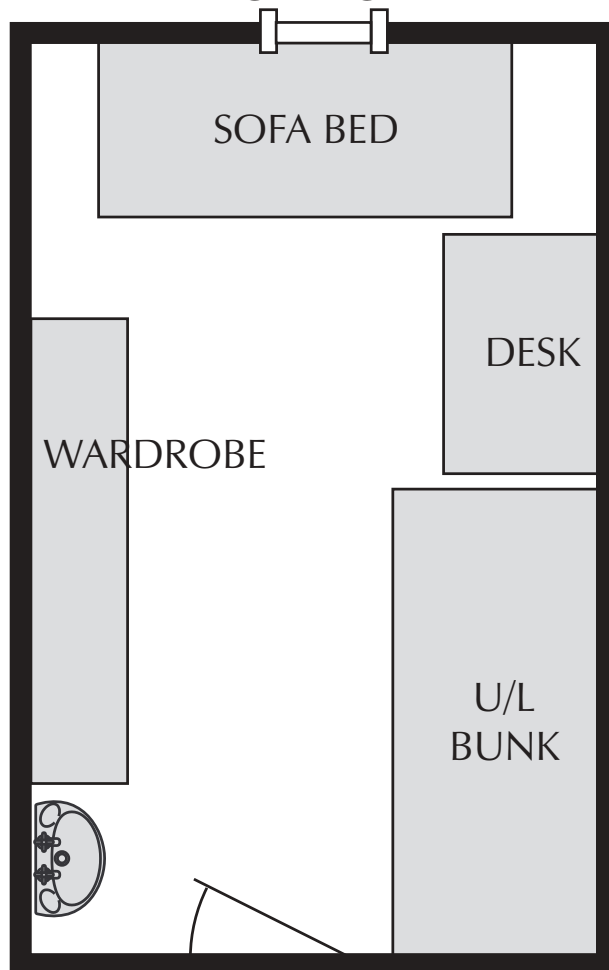

TOILET/
SHOWER
FACILITIES
SHARED

Note: Diagram is not to scale. Some individual cabin layouts may vary.

Peregrine Voyager

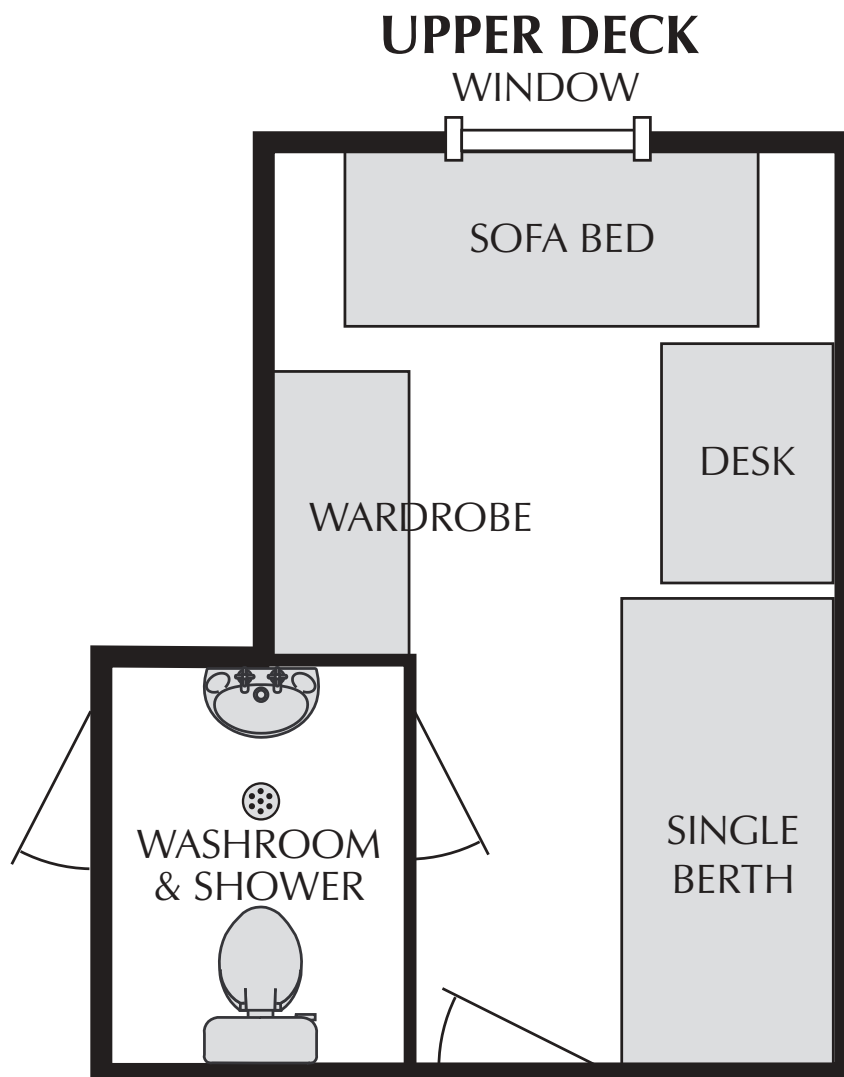

Note: Diagram is not to scale. Some individual cabin layouts may vary.

Peregrine Voyager

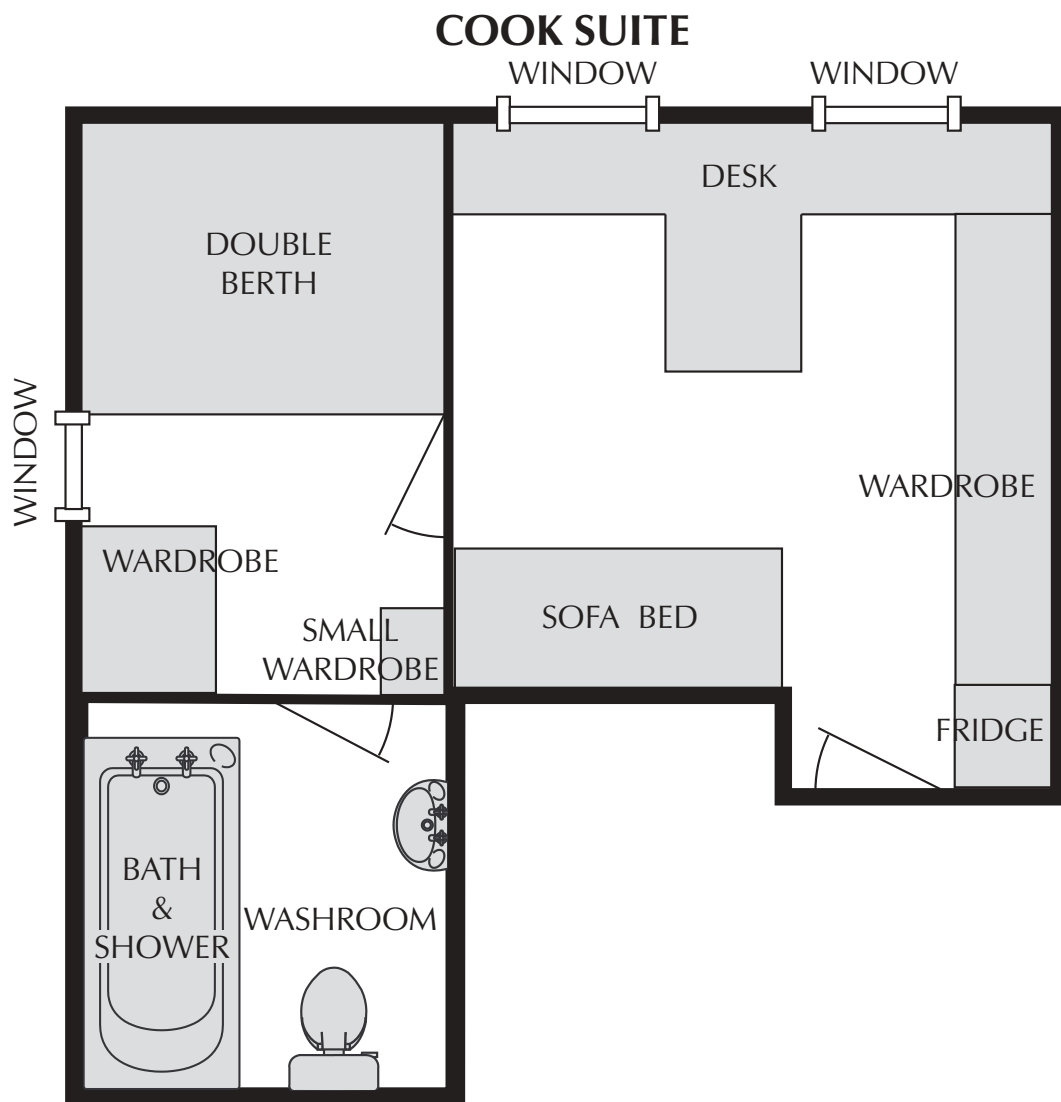

Note: Diagram is not to scale. Some individual cabin layouts may vary.

Peregrine Voyager

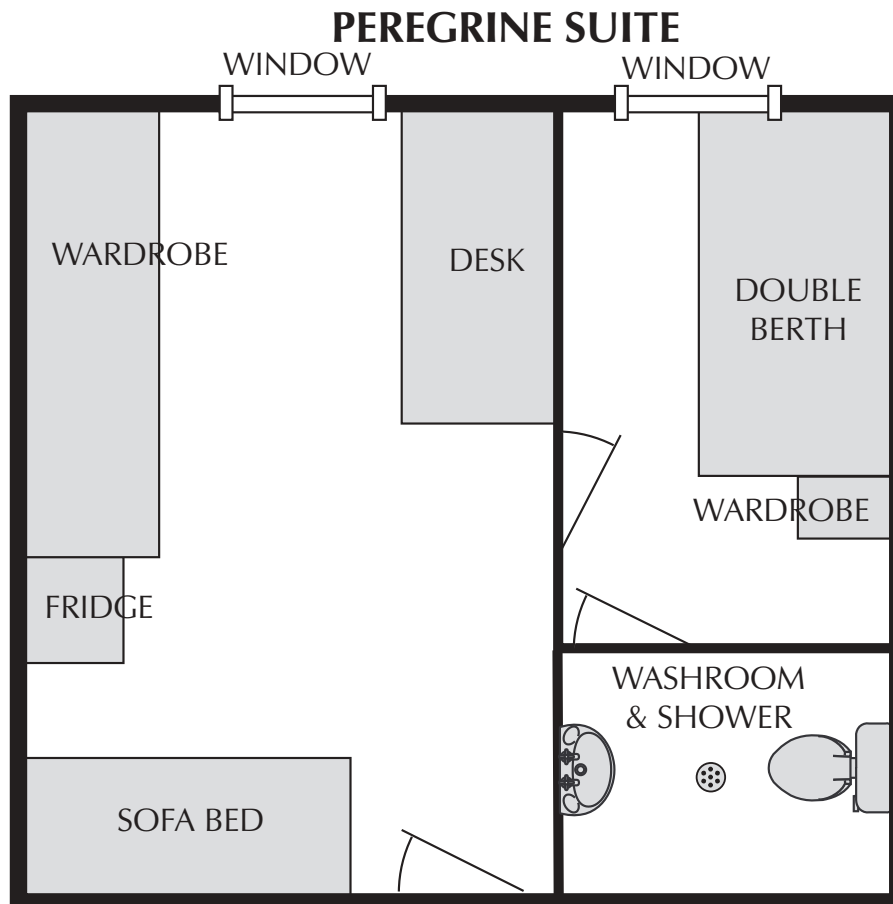

Note: Diagram is not to scale. Some individual cabin layouts may vary.

Peregrine Voyager



AKADEMIK SERGEY VAVILOV/PEREGRINE VOYAGER

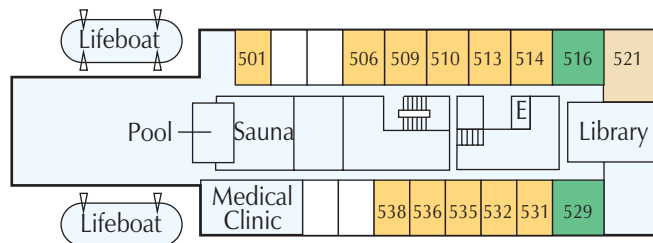

Deck 5

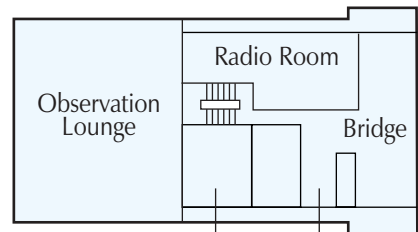

Deck 6

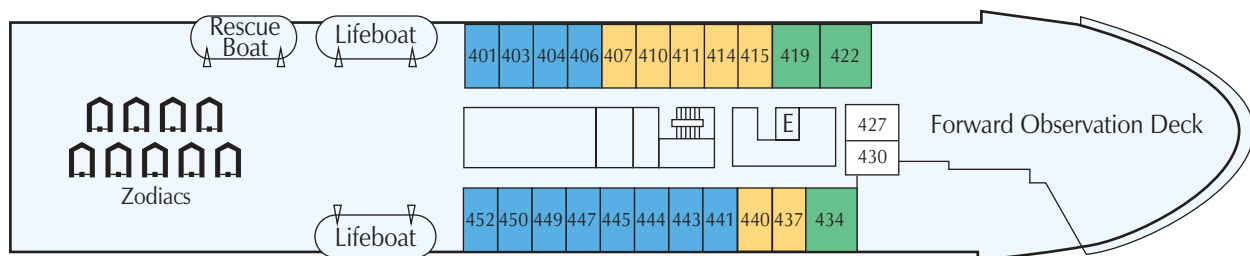

Deck 4

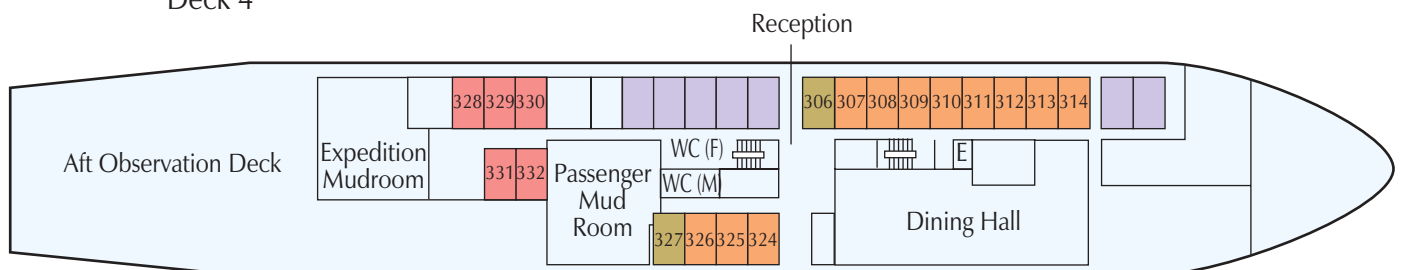

Deck 3

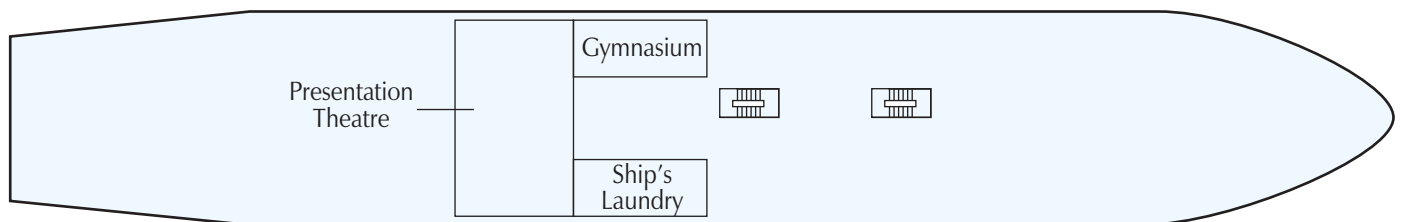

Deck 1

Main Deck Triple - Bunk beds and a sofa bed. Facilities are shared and there is a washbasin in the cabin, writing desk, porthole.

Main Deck Twin - Bunk beds and shared facilities, washbasin in cabin. Writing desk, porthole.

Upper Deck Twin - 1 lower berth, 1 sofa bed and semi-private (one bathroom between two cabins) facilities. Writing desk, window.

Superior - 1 sofa bed, 1 lower berth and private facilities. Writing desk, window.

Superior Plus - 2 lower berths, sofa and private facilities. Writing desk, portholes.

Peregrine Suite - 1 double berth, 1 sofa bed, separate sleeping quarters and private facilities, up-graded bedding. Fridge, TV, VCR, writing desk, windows.

Cook Suite - Double berth, 1 sofa bed, separate sleeping quarters and private facilities, bathtub, up-graded bedding. Fridge, TV, VCR, writing desk, windows overlooking the bow.

Peregrine
The Spirit of Adventure